

MOTOPLASTIC, S.A.

Molí de la sal, 1 - 08400 Granollers (Barcelona) SPAIN

Tel. 34 93 849 06 33 - Fax 34 93 849 09 88

info@puig.tv

www.puig.tv

INSTRUCCIONES DE MONTAJE - MOUNTING INSTRUCTIONS

VISERA PARA EVITAR EL "EFECTO LUPA" DE LA CÚPULA
 PLATE TO AVOID "GLASS EFFECT" OF THE SCREEN

HONDA CBR 600 RR '07 - '12

Ref.: 4356

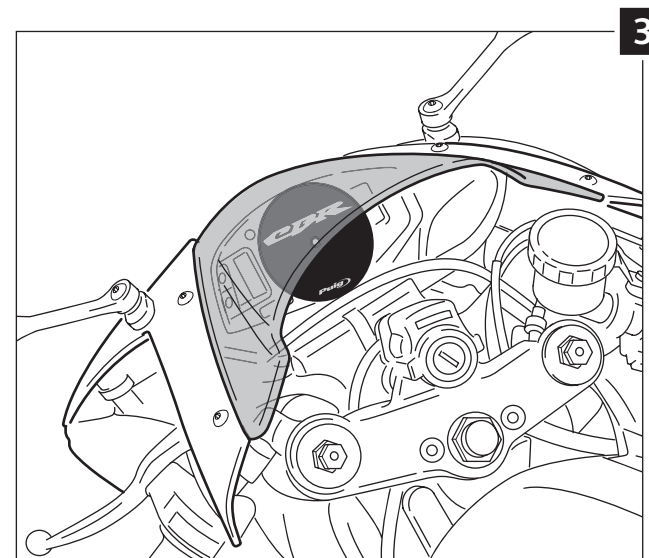
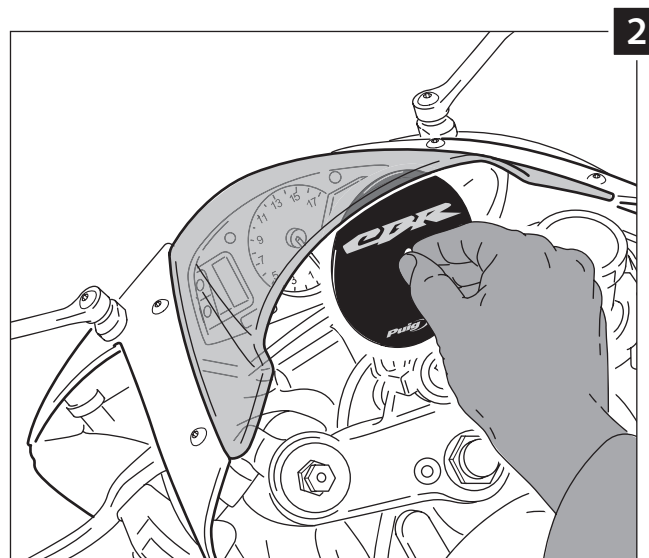
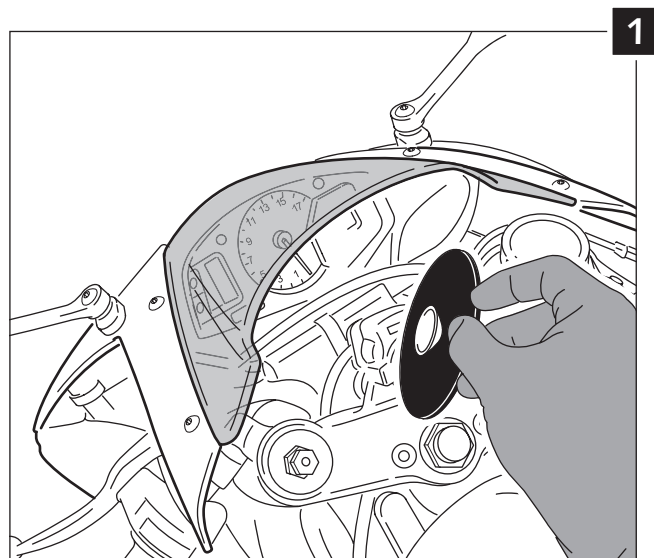



ATENCIÓN

Para evitar daños en la zona del cuentakilómetros se recomienda poner la visera tal y como se indica en la hoja de instrucciones, cada vez que se deje la moto aparcada de espaldas al sol.

ATTENTION

To avoid damages on the dash, it is recommended to place the plate as the instructions show when the sun-rays hit the bike from the back.

ID.	DESCRIPCIÓN	DESCRIPTION	QTY.
1	 Visera	Plate	1
2	 Ventosa Ø20mm	Suction pad Ø20mm	1